

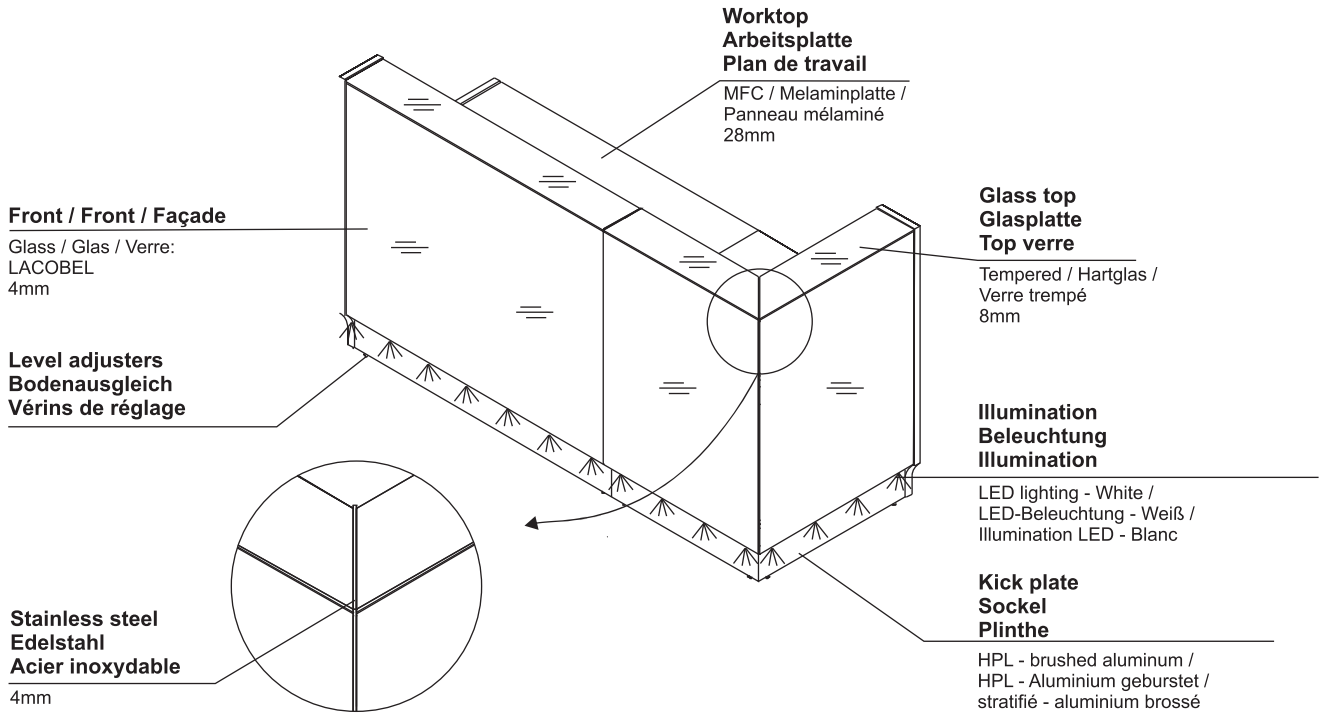

TECHNICAL SPECIFICATION / TECHNISCHE BESCHREIBUNG / DESCRIPTION TECHNIQUE



**Worktop with optional
monitor shelf (160 EURO)
Arbeitsplatte mit
Monitorboden (als Option)
Plan de travail avec découpe
et support pour l'écran en option**

MFC / Melaminplatte /
Panneau mélaminé
28mm

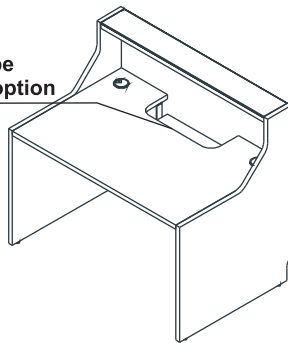

**Side panel
Wangenfuß
Pied latéral**

MFC / Melaminplatte /
Panneau mélaminé
28mm

**Cable-way
Kabeldurchlass
Obturateur**

∅ 80mm

**Supporting leg where worktops connect
Stützfuß
Nécessaire sur la jonction des banquettes**

NL41 required on all connections of receptions /
NL41 Stützfuß zusätzlich zur Verbindung der Thekenelemente bestellen /
NL41 nécessaire sur la connexion des banquettes

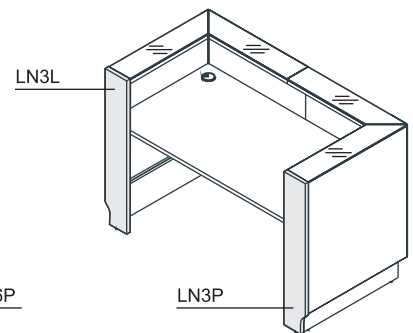
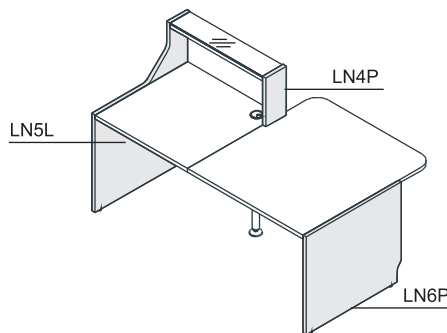
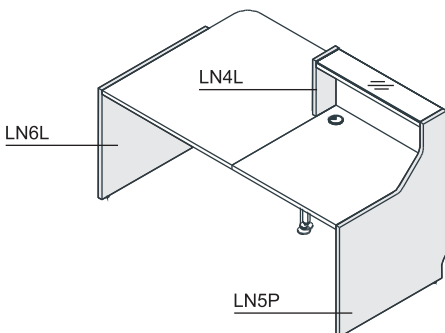
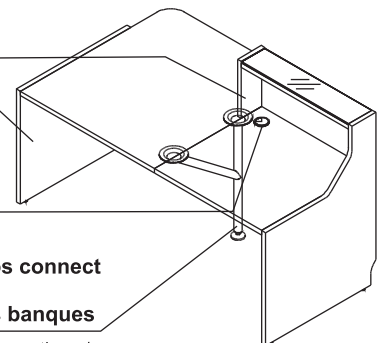



TECHNICAL SPECIFICATION / TECHNISCHE BESCHREIBUNG / DESCRIPTION TECHNIQUE

Top Oberplatte Plateau

MFC / Melaminplatte /
Panneau mélaminé
12mm

Body Korpus Corps

MFC / Melaminplatte /
Panneau mélaminé
18mm

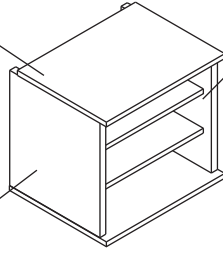

Shelf Boden Plateau

MFC / Melaminplatte /
Panneau mélaminé
12mm

Door Tür Porte

MFC / Melaminplatte /
Panneau mélaminé
12mm

Lock / Verschluss / Serrure

- central lock
- Zentralverschluss
- serrure centralisée

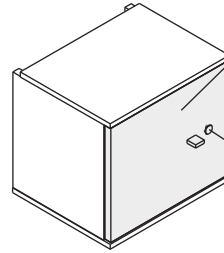

DIMENSIONS / ABMESSUNG / DIMENSIONS

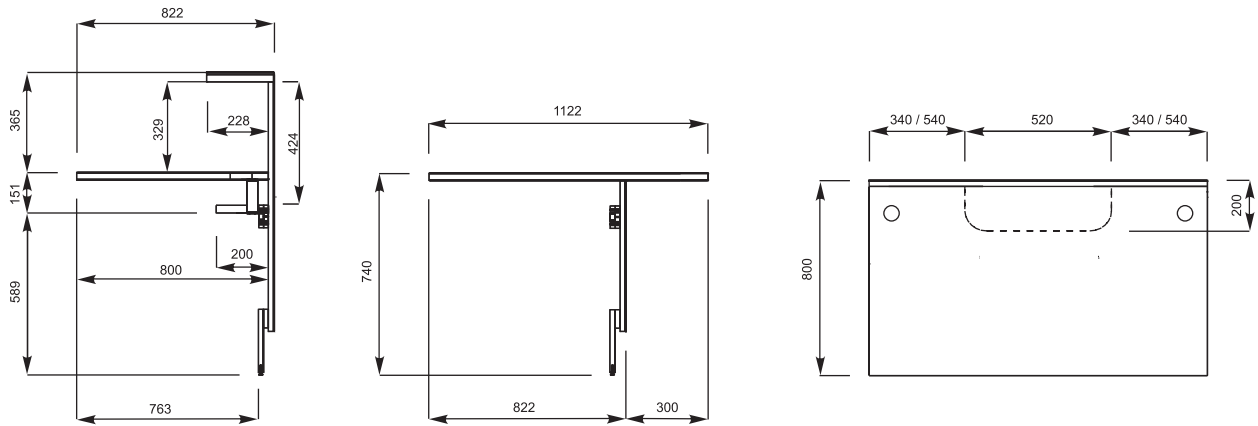

FINISHES / FARBEN / FINITIONS

67-WHITE PASTEL WEIß PASTELL BLANC PASTEL	TEMPERED GLASS, WHITE HARTGLAS, WEIß VERRE TREMPÉ, BLANC			15 METAL, HIGH GLOSS WHITE METALL, WEIß GLANZ METAL, BLANC BRILLANT		
08-BLACK SCHWARZ NOIR	TEMPERED GLASS, BLACK HARTGLAS, SCHWARZ VERRE TREMPÉ, NOIR			08 METAL, BLACK METALL, SCHWARZ METAL, NOIR		
26-ALUMINIUM SATINATO ALUMINIUM SATINATO ALUMINIUM SATINE	TEMPERED GLASS, SILVER HARTGLAS, SILBERN VERRE TREMPÉ, ARGENT			15 METAL, HIGH GLOSS WHITE METALL, WEIß GLANZ METAL, BLANC BRILLANT		
116-BLACK SCHWARZ NOIR	117- WHITE WEIß BLANC	124-SILVER SILBERN ARGENT	134-DARK TURQUOISE TÜRKIS TURQUOISE	135-YELLOW GELB JAUNE	136-FUCHSIA PINK ROSE	
26-ALUMINIUM SATINATO ALUMINIUM SATINATO ALUMINIUM SATINE	67-WHITE PASTEL WEIß PASTELL BLANC PASTEL	08-BLACK SCHWARZ NOIR				
30-WHITE WEIß BLANC	08-BLACK SCHWARZ NOIR	09-ALUMINIUM ALUMINIUM ALUMINIUM				Tambour Jalousie Rideaux



RECEPTION DESK SYSTEMS / EMPFANGSTHEKEN-SYSTEME / CONFIGURATIONS DES BANQUES

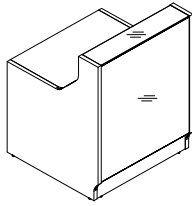

LN5P+LN12+LNB13+LN5L

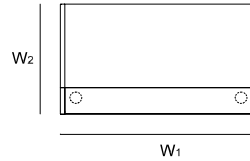
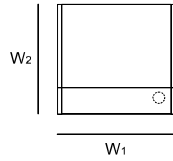

INDEX SYMBOL	DIMENSIONS / ABMESSUNGEN [mm]						⚖️	📦	📦		COMMENTS / BEMERKUNGEN / REMARQUES
	W ₁	W ₂	D ₁	D ₂	H						
⁰⁸ LIN08 ⁰⁸	856	824	-	-	1105		70.5	0.350	7		
¹² LIN13 ¹³	1256	824	-	-	1105		91.5	0.488	8		

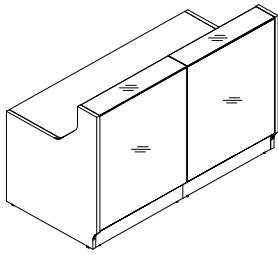

LN5P+LN08+LN08+LNB15+LN5L

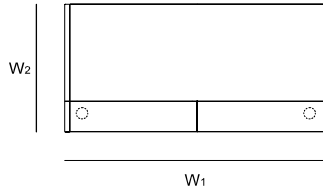

INDEX SYMBOL	DIMENSIONS / ABMESSUNGEN [mm]						⚖️	📦	📦		COMMENTS / BEMERKUNGEN / REMARQUES
	W ₁	W ₂	D ₁	D ₂	H						
LIN15 ¹⁵	1656	824	-	-	1105		112.0	0.637	12		

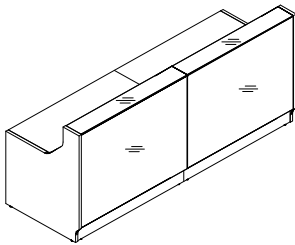

LN5P+LN12+LNB13+NL41+LN12+LNB13+LN5L

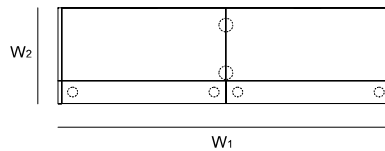

INDEX SYMBOL	DIMENSIONS / ABMESSUNGEN [mm]						⚖️	📦	📦		COMMENTS / BEMERKUNGEN / REMARQUES
	W ₁	W ₂	D ₁	D ₂	H						
¹³ LIN25 ¹³	2456	824	-	-	1105		160.0	0.979	16		

DESCRIPTION / LEGENDE / LÉGENDE:

⚖️ net weight / Nettogewicht / poids net

📦 volume / Volumen / le volume

📦 number of packages / Stückzahl der Pakete / nombre de colis



RECEPTION DESK SYSTEMS / EMPFANGSTHEKEN-SYSTEME / CONFIGURATIONS DES BANQUES

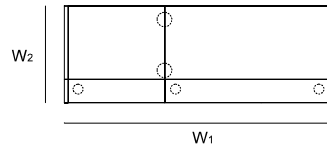
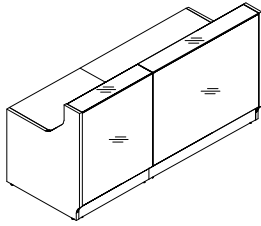

LN5P+LN08+LNB08+NL41+LN12+LNB13+LN5L

INDEX SYMBOL	DIMENSIONS / ABMESSUNGEN [mm]						⚖️	📦	📦		COMMENTS / BEMERKUNGEN / REMARQUES
	W ₁	W ₂	D ₁	D ₂	H						
08 LIN20 13	2056	824	-	-	1105		136.0	0.835	14		

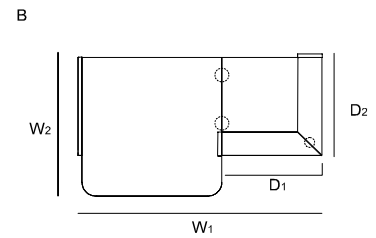
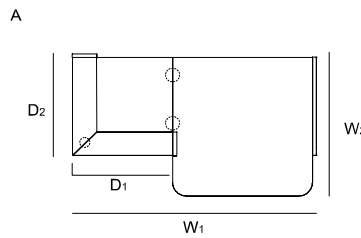
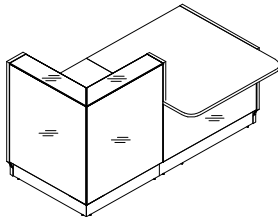

A: LN3P+LN91+LNB08+NL41+LN4L+LNU11+LN6L
 B: LN6P+LNU11+NL41+LN4P+LNB08+LN91+LN3L

INDEX SYMBOL		DIMENSIONS / ABMESSUNGEN [mm]						⚖️	📦	📦		COMMENTS / BEMERKUNGEN / REMARQUES
A	B	W ₁	W ₂	D ₁	D ₂	H						
LIN29L 15	LIN29P 15	1850	1150	822	850	1105		149.5	1.305	13		

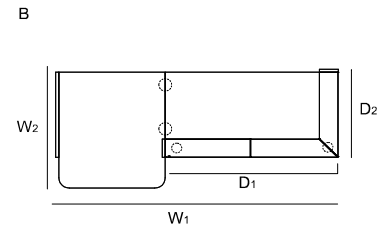
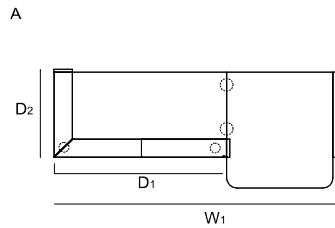
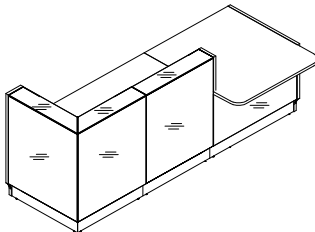

A: LN3P+LN91+LNB15+LN08+NL41+LN4L+LNU11+LN6L
 B: LN6P+LNU11+NL41+LN4P+LN08+LNB15+LN91+LN3L

INDEX SYMBOL		DIMENSIONS / ABMESSUNGEN [mm]						⚖️	📦	📦		COMMENTS / BEMERKUNGEN / REMARQUES
A	B	W ₁	W ₂	D ₁	D ₂	H						
LIN35L	LIN35P	2650	1150	-	-	1105		191.0	1.593	18		

DESCRIPTION / LEGENDE / LÉGENDE:

⚖️ net weight / Nettogewicht / poids net

📦 volume / Volumen / le volume

📦 number of packages / Stückzahl der Pakete / nombre de colis



RECEPTION DESK SYSTEMS / EMPFANGSTHEKEN-SYSTEME / CONFIGURATIONS DES BANQUES

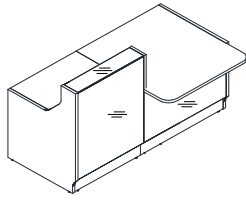

A

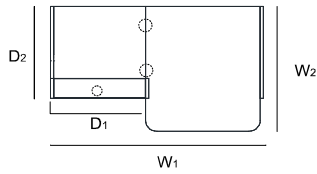

B

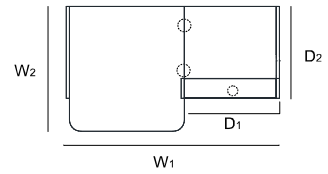

A: LN5P+LN08+LNB08+NL41+LN4L+LNU11+LN6L
 B: LN6P+LNU11+NL41+LN4P+LN08+LNB08+LN5L

INDEX SYMBOL		DIMENSIONS / ABMESSUNGEN [mm]						⚖️	📦	📦		COMMENTS / BEMERKUNGEN / REMARQUES
A	B	W ₁	W ₂	D ₁	D ₂	H						
⁰⁸ LIN33L	⁰⁸ LIN33P	1856	1122	828	824	1105		97.5	0.506	13		

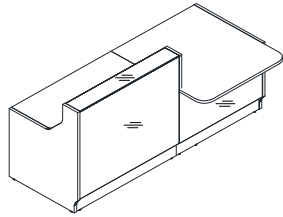

A

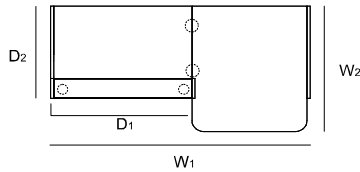

B

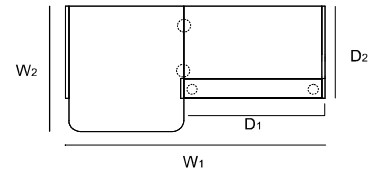

A: LN5P+LN12+LNB13+NL41+LN4L+LNU11+LN6L
 B: LN6P+LNU11+NL41+LN4P+LN12+LNB13+LN5L

INDEX SYMBOL		DIMENSIONS / ABMESSUNGEN [mm]						⚖️	📦	📦		COMMENTS / BEMERKUNGEN / REMARQUES
A	B	W ₁	W ₂	D ₁	D ₂	H						
¹³ LIN34L	¹³ LIN34P	2256	1122	1228	824	1105		126.5	0.710	14		

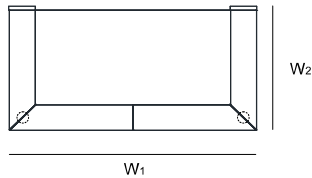
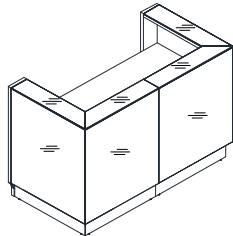

LN3P+LN91+LNB15+LN91+LN3L

INDEX SYMBOL		DIMENSIONS / ABMESSUNGEN [mm]						⚖️	📦	📦		COMMENTS / BEMERKUNGEN / REMARQUES
		W ₁	W ₂	D ₁	D ₂	H						
LIN36		¹⁵ 1644	850	-	-	1105		200.0	2.105	12		

DESCRIPTION / LEGENDE / LÉGENDE:

⚖️ net weight / Nettogewicht / poids net

📦 volume / Volumen / le volume

📦 number of packages / Stückzahl der Pakete / nombre de colis



RECEPTION DESK SYSTEMS / EMPFANGSTHEKEN-SYSTEME / CONFIGURATIONS DES BANQUES

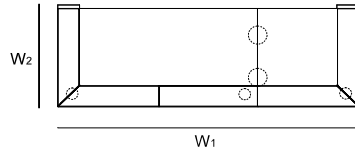
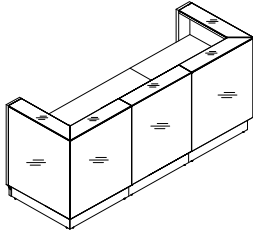

2xLN91+LN08+LNB15+LNB08+LN3L+LN3P+NL41

INDEX SYMBOL	DIMENSIONS / ABMESSUNGEN [mm]						⚖️	📦	📦		COMMENTS / BEMERKUNGEN / REMARQUES
	W ₁	W ₂	D ₁	D ₂	H						
15 LIN42 08	2444	850	-	-	1105		243.0	2.445	15		

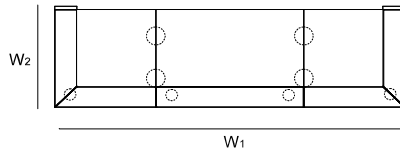
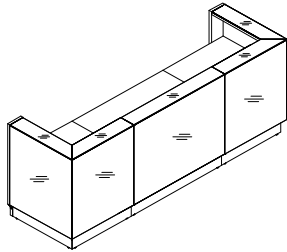

2xLN91+LN12+LNB13+2xLNB08+LN3L+LN3P+2xNL41

INDEX SYMBOL	DIMENSIONS / ABMESSUNGEN [mm]						⚖️	📦	📦		COMMENTS / BEMERKUNGEN / REMARQUES
	W ₁	W ₂	D ₁	D ₂	H						
13 LIN43 08	2844	850	-	-	1105		267.0	2.643	17		

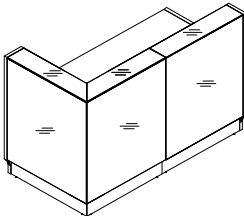

A

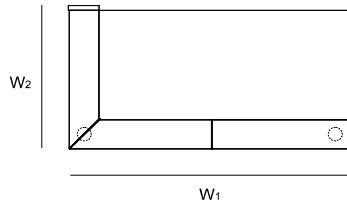

B

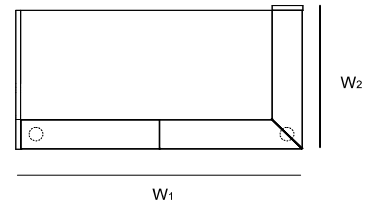

A: LN3P+LN91+LNB15+LN08+LN5L

B: LN5P+LN08+LNB15+LN91+LN3L

INDEX SYMBOL		DIMENSIONS / ABMESSUNGEN [mm]						⚖️	📦	📦		COMMENTS / BEMERKUNGEN / REMARQUES
A	B	W ₁	W ₂	D ₁	D ₂	H						
15 LIN37L	15 LIN37P	1650	850	-	-	1105		156.0	1.371	12		

DESCRIPTION / LEGENDE / LÉGENDE:

⚖️ net weight / Nettogewicht / poids net

📦 volume / Volumen / le volume

📦 number of packages / Stückzahl der Pakete / nombre de colis



RECEPTION DESK SYSTEMS / EMPFANGSTHEKEN-SYSTEME / CONFIGURATIONS DES BANQUES

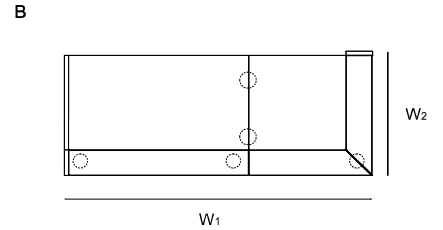
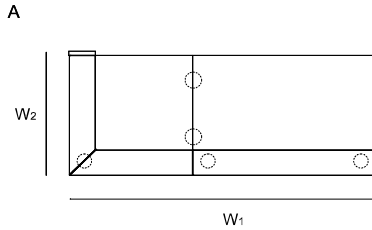
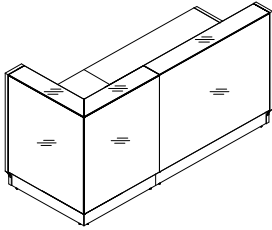

A: LN3P+LN91+LNB08+NL41+LN12+LNB13+LN5L
 B: LN5P+LN12+LNB13+NL41+LNB08+LN91+LN3L

INDEX SYMBOL		DIMENSIONS / ABMESSUNGEN [mm]						⚖️	📦	📦		COMMENTS / BEMERKUNGEN / REMARQUES
A	B	W ₁	W ₂	D ₁	D ₂	H						
¹³ LIN38L	¹³ LIN38P	2050	850	-	-	1105		180.0	1.569	14		

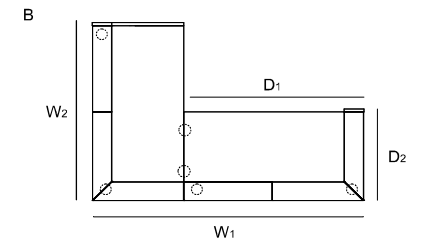
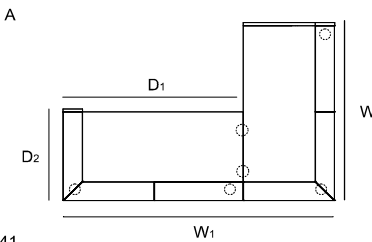
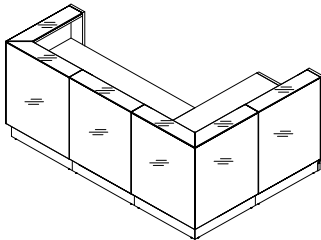

A: LN3P+LN91+LNB15+LN08+LN91+LNB15+LN08+LN5L+NL41
 B: LN5P+LN08+LNB15+LN91+LN08+LNB15+LN91+LN3L+NL41

INDEX SYMBOL		DIMENSIONS / ABMESSUNGEN [mm]						⚖️	📦	📦		COMMENTS / BEMERKUNGEN / REMARQUES
A	B	W ₁	W ₂	D ₁	D ₂	H						
¹⁵ LIN39L	¹⁵ LIN39P	2444	1650	1622	850	1105		296.0	2.764	24		

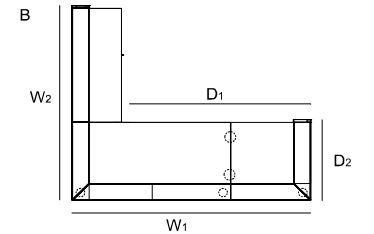
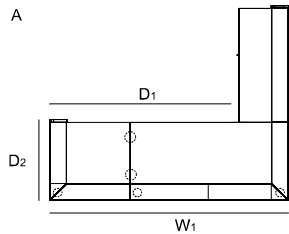
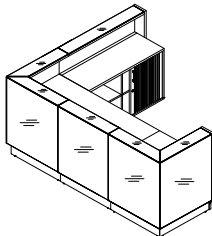

A: LN3P+LN91+LNB08+LNB15+LN08+LN91+NL41+LN12+L2Z06+LN3L
 B: LN3L+L2Z06+LN12+LN91+LN08+LNB15+LNB08+NL41+LN91+LN3P

INDEX SYMBOL		DIMENSIONS / ABMESSUNGEN [mm]						⚖️	📦	📦		COMMENTS / BEMERKUNGEN / REMARQUES
A	B	W ₁	W ₂	D ₁	D ₂	H						
⁰⁸ LIN40L	¹⁵ LIN40P	2444	2050	1950	850	1105		336.5	3.301	24		

DESCRIPTION / LEGENDE / LÉGENDE:

⚖️ net weight / Nettogewicht / poids net

📦 volume / Volumen / le volume

📦 number of packages / Stückzahl der Pakete / nombre de colis



RECEPTION DESK SYSTEMS / EMPFANGSTHEKEN-SYSTEME / CONFIGURATIONS DES BANQUES

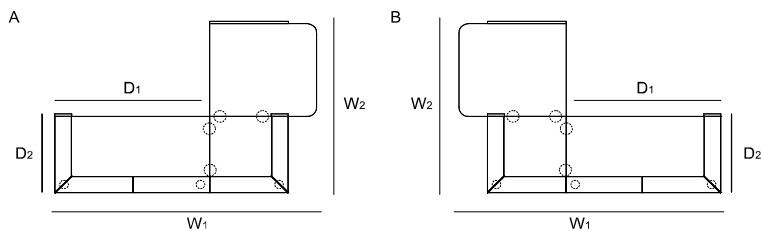
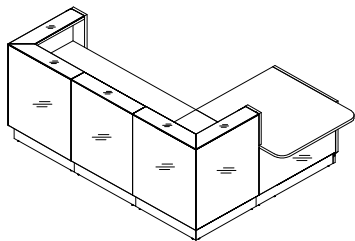

A: LN3P+LN91+LNB15+LN08+NL41+LN91+NL41+LNB08+LNU11+LN4L+LN6L
 B: LN6P+LNU11+LN4P+LNB08+NL41+LN91+NL41+LN08+LNB15+LN91+LN3L

INDEX SYMBOL		DIMENSIONS / ABMESSUNGEN [mm]						kg	m ³	pcs		COMMENTS / BEMERKUNGEN / REMARQUES
A	B	W ₁	W ₂	D ₁	D ₂	H						
¹⁵ LIN41L ⁰⁸	¹⁵ LIN41P ⁰⁸	2744	1850	1622	850	1105	286.5	2.692	24			

DESCRIPTION / LEGENDE / LÉGENDE:

net weight / Nettogewicht / poids net

volume / Volumen / le volume

number of packages / Stückzahl der Pakete / nombre de colis



PRODUCT ILLUSTRATION / PRODUKTANSICHT UND SKIZZE / VUE DE PRODUIT	DIMENSIONS / ABMESSUNGEN [mm]			INDEX SYMBOL						COMMENTS / BEMERKUNGEN / REMARQUES
	WIDTH / BREITE / LARGEUR	DEPTH / TIEFE / PROFONDEUR	HEIGHT / HÖHE / HAUTEUR			kg	m3	pcs		

ELEMENTS / BAUTEILE / ÉLÉMENTS COMPOSANTS

	800	250	1105	LN08		28.5	0.259	4		
	1200	250	1105	LN12		42.5	0.380	4		
	822	822	1105	LN91		79.5	1.011	4		
	1000	1122	740	LNU11		32.5	0.161	4		
	800	800	28	LNB08		14.0	0.025	1		
	1200	800	28	LNB13		21.0	0.042	2		
	1600	800	28	LNB15		27.0	0.054	2		
	254	28	1105	LN3L		7.0	0.014	1		-left / -links / -gauche
	254	28	1105	LN3P		7.0	0.014	1		-right / -rechts / -droit
	254	28	367	LN4L		2.5	0.006	1		-left / -links / -gauche
	254	28	367	LN4P		2.5	0.006	1		-right / -rechts / -droit

DESCRIPTION / LEGENDE / LÉGENDE:

net weight / Nettogewicht / poids net

volume / Volumen / le volume

number of packages / Stückzahl der Pakete / nombre de colis



PRODUCT ILLUSTRATION / PRODUKTANSICHT UND SKIZZE / VUE DE PRODUIT	DIMENSIONS / ABMESSUNGEN [mm]			INDEX SYMBOL						COMMENTS / BEMERKUNGEN / REMARQUES
	WIDTH / BREITE / LARGEUR	DEPTH / TIEFE / PROFONDEUR	HEIGHT / HÖHE / HAUTEUR			kg	m3	pcs		

ELEMENTS / BAUTEILE / ÉLÉMENTS COMPOSANTS

	824	28	1105	LN5L		14.0	0.033	1		-left / -links / -gauche
	824	28	1105	LN5P		14.0	0.033	1		-right / -rechts / -droit
	824	28	740	LN6L		12.0	0.024	1		-left / -links / -gauche
	824	28	740	LN6P		12.0	0.022	1		-right / -rechts / -droit
	345	283	314	LMS05		5.0	0.031	1		
	339	18	286	LMS06		2.0	0.005	1		
	1200	532	740	L2Z06		49.5	0.469	2		
	585	142	690	NL41		2.0	0.063	1		
	460	70	87	E64		0.0	0.000	0		horizontal cable tray 09-aluminum / Kabelkanal 09 - Aluminium / bac à câble - 09 aluminium

DESCRIPTION / LEGENDE / LÉGENDE:

net weight / Nettogewicht / poids net

volume / Volumen / le volume

number of packages / Stückzahl der Pakete / nombre de colis